



≈ 220 - 240 V 0/50/60 Hz IP 54 IK04



7 x 2,5 mm²
7 x 1,5 mm²



1,5 - 2,50 mm²

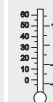

Umgebungstemperatur /
temperature ambiante
=> -25 °C ... + 50 °C

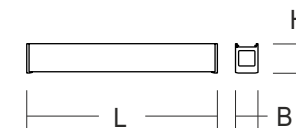
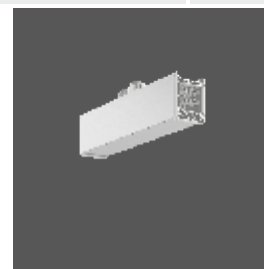

| | | [mm] | | |
|--|------------------------------|--|-----------|----------------|
| | 982698.00X 982698.00X.3 | L 330,5, B 58, H 76 L 330,5, B 58, H 76 | 14x 7x | 680 g 620 g |
| | 982698.00X.1 982698.00X.4 | L 312 B 58, H 76 L 312 B 58, H 76 | 14x 7x | 680 g 620 g |
| | 982698.00X.2 982698.00X.5 | L 349 B 58, H 76 L 349 B 58, H 76 | 14x 7x | 680 g 620 g |

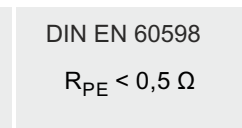
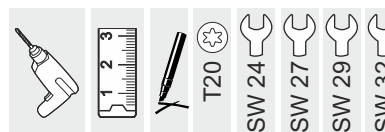



1

Pendelmontage / Pendant mounting
Einspeisung von Oben / Feed from above

Deckenmontage / Ceiling mounting
Einspeisung von Oben / Feed from above

Stecker / Plug

Buchse / Socket

i

2

Werkseinstellung / Factory setting

9

i

3a

i

3b

i

4a

| | L | X* |
|--|-----------|------------|
| | ≤ 4500 mm | ≤ 60000 mm |
| | ≤ 2270 mm | ≤ 50000 mm |

* R_{PE} < 0,5 Ω
EN 60598

! 1x
■ ≤ 12 kg





4b

4c

| | L | X* | * R _{PE} < 0,5 Ω EN 60598 |
|---------|-----------|------------|---------------------------------------|
| 4547 mm | ≤ 2200 mm | ≤ 60000 mm | |
| 2291 mm | ≤ 1100 mm | ≤ 50000 mm | |

4d

5

6

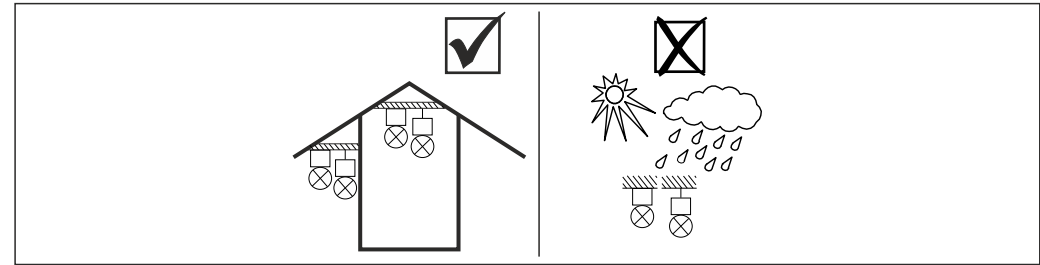
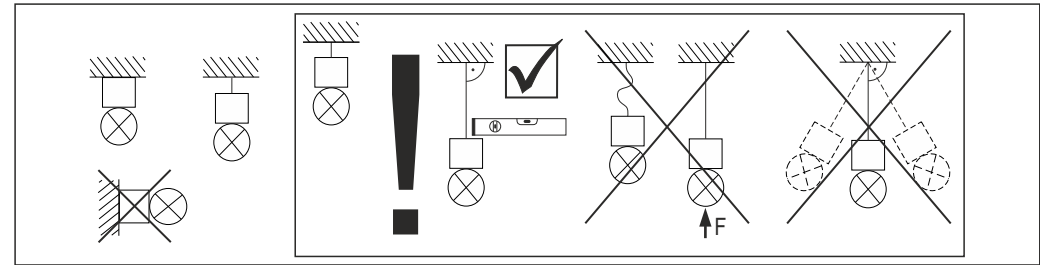
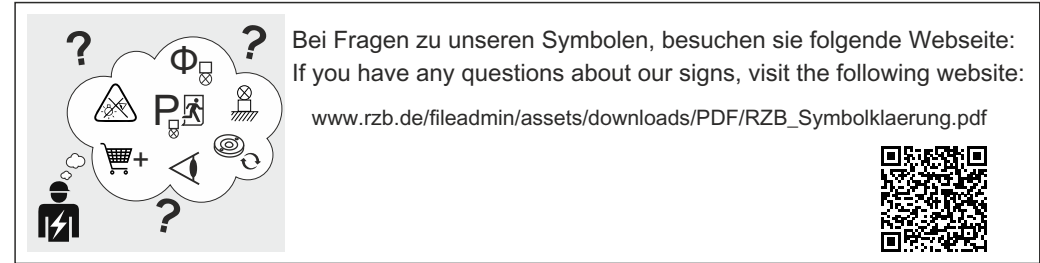
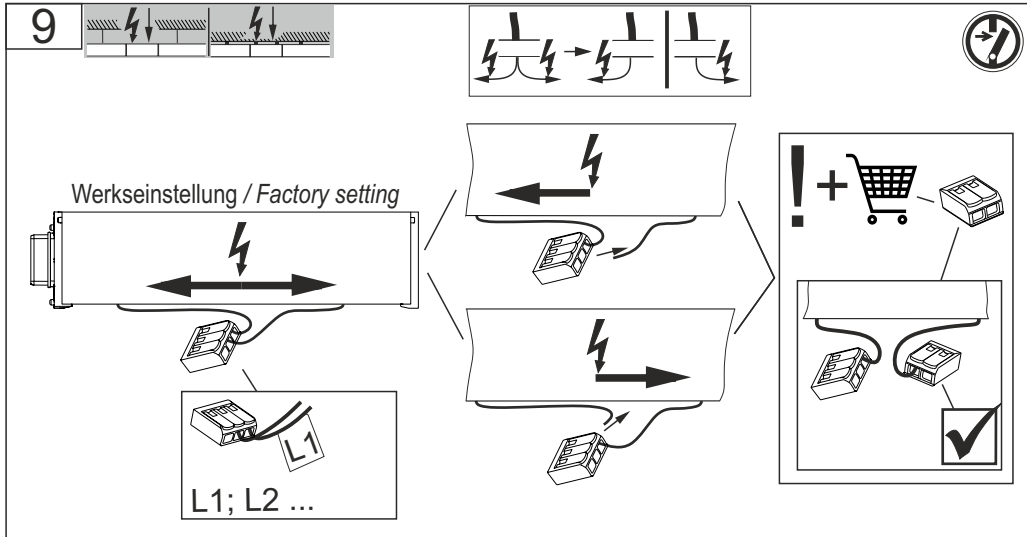
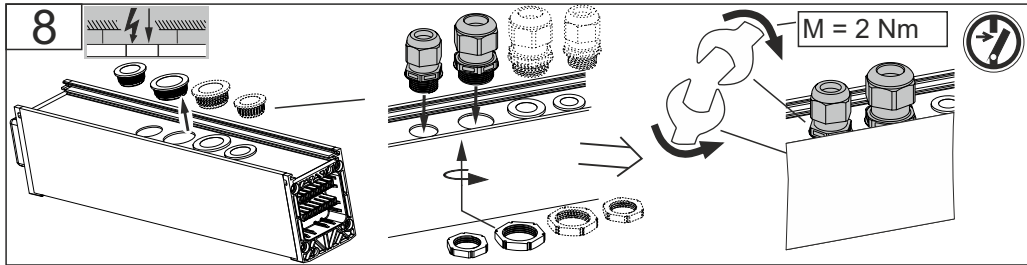
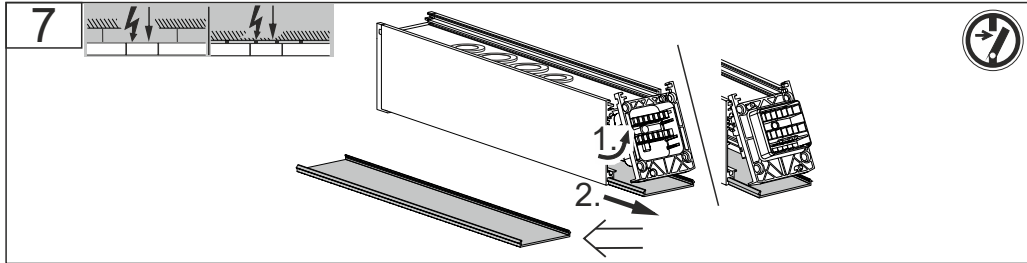

Hinweis zum Einsatz von Leuchten mit D -Kennzeichnung nach EN 60598-2-24
Reference for application of lumiaires with D - marking according to EN 60598-2-24

| | |
|-------|--|
| IP 4x | Umgebung ohne Staubablagerung Environment without dust deposit |
| IP 5x | Umgebung mit nicht elektrisch leitender Staubablagerung Environment with non-electrically conductive dust deposit |
| IP 6x | Umgebung mit elektrisch leitender Staubablagerung Environment with electrically conductive dust deposit |

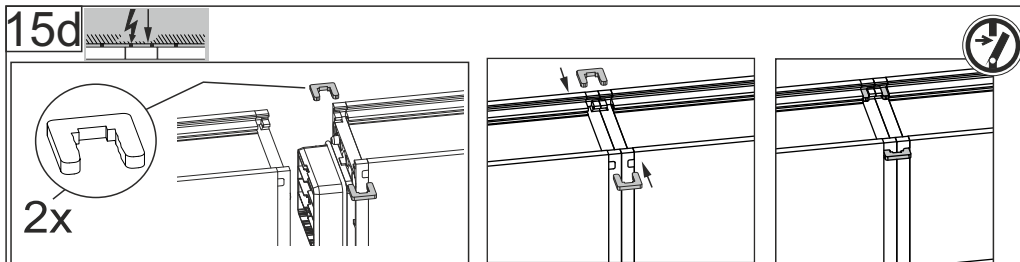
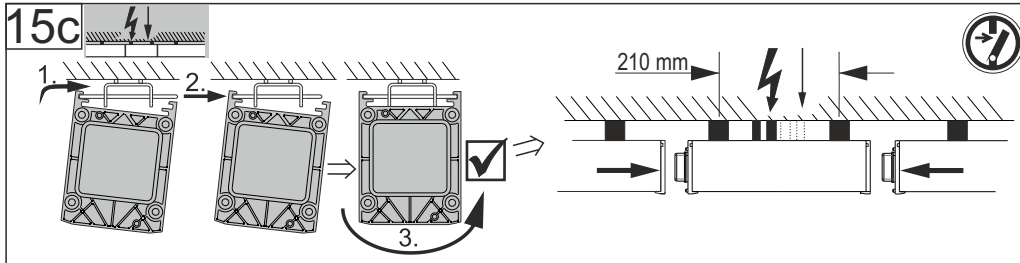
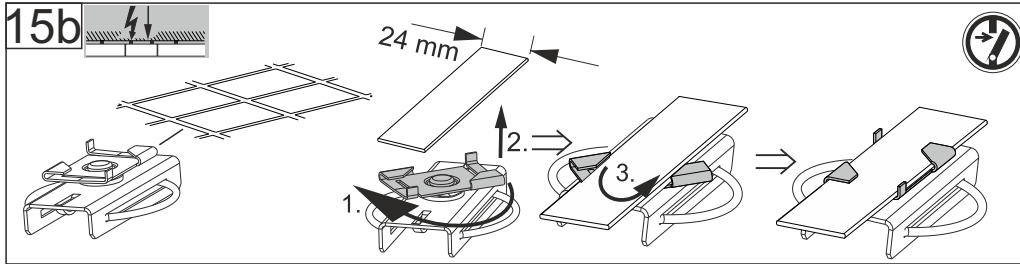
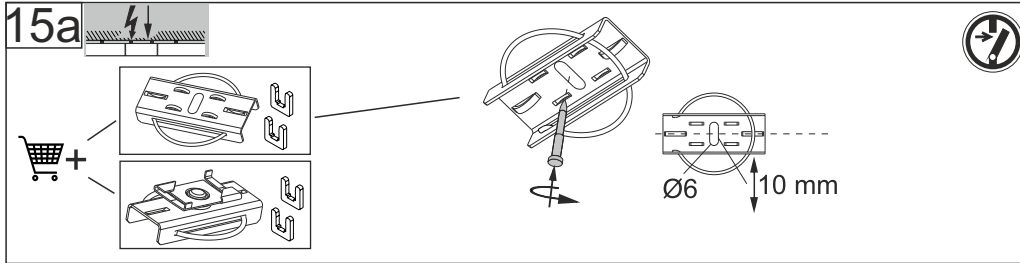

Verdrahtung / wiring

| | | I max. | 7x | 14x |
|-------------|---|--------|----|-----|
| L1 | Phase 1 / phase 1 | 16 A | | |
| L2 | Phase 2 / phase 2 | 16 A | | |
| L3 | Phase 3 / phase 3 | 16 A | | |
| PE/⊕ | Schutzleiter / Protective conductor | | | |
| N | Neutralleiter / Neutral conductor | | | |
| D1 | DALI DA / DALI DA | | | |
| D2 | DALI DA / DALI DA | | | |
| 1 | Notbeleuchtung Kreis 1 / emergency lighting circle 1 | 6 A | | |
| 2 | Notbeleuchtung Kreis 1 / emergency lighting circle 1 | 6 A | | |
| 3 | Steuer oder geschaltetes Signal / Control or switched signal | | | |
| 4 | Schutzleiter (Notbeleuchtung) / Protective conductor (emergency lighting) | | | |
| 5 | Steuer oder geschaltetes Signal / Control or switched signal | | | |
| 6 | Notbeleuchtung Kreis 2 / emergency lighting circle 2 | 6 A | | |
| 7 | Notbeleuchtung Kreis 2 / emergency lighting circle 2 | 6 A | | |

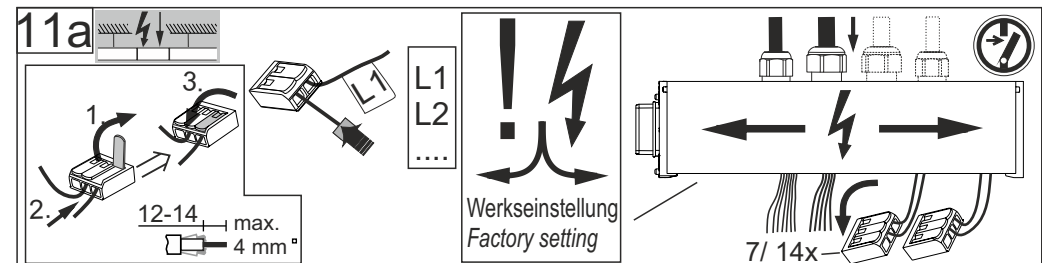
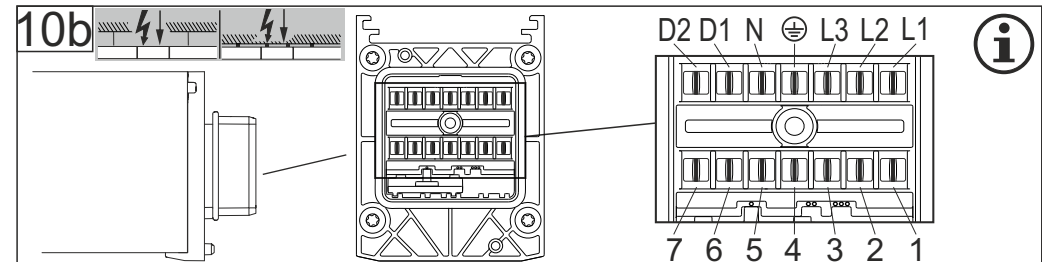
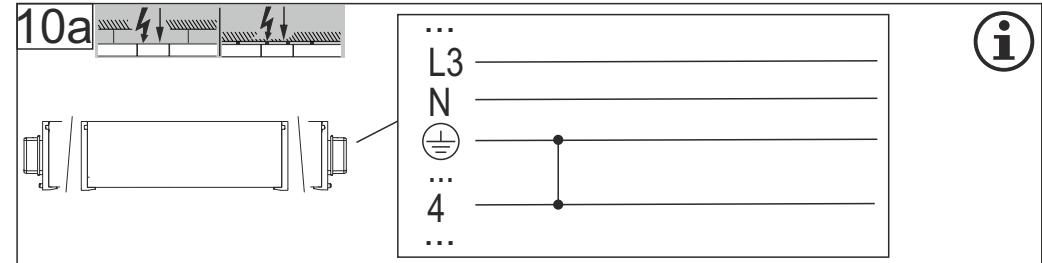



11b

L1
L2
....

! ⚡
Werkseinstellung
Factory setting

12-14 max.
4 mm

7/ 14x

12

! M < 0,5 Nm

4x

! M < 0,5 Nm



13

982680.000

≥ 90 mm

M = 2 Nm

14

M = 2 Nm