

# INSTRUCTION

Less is more 27  
312178.004.76



~ 220 - 240 V 50/60 Hz IP 20, IP 20 IK00



 4 x 1,5 mm<sup>2</sup>

 1,50 mm<sup>2</sup>



 Umgebungstemperatur /  
temperature ambiante  
=> -25 °C ... + 25 °C

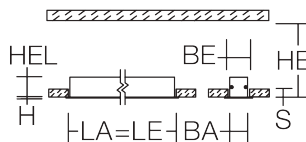
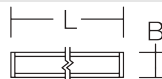
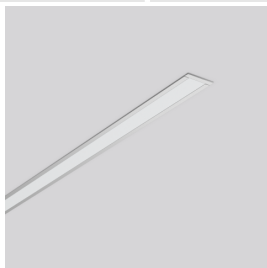

L 1514, B 38, H 2, HEL 37

LA 1506, BA 30, HE 45-60, S 10-30

1,26 kg



$\Phi$  [lm]

$P_{\text{in}}$  [W]

$P_{\text{out}}$

LED

2400

43

1 x 32,7 W

CCT [K]

CRI

RG

EEK

3000

82

RG 1

E



B10 [St.]

B16 [St.]

C10 [St.]

C16 [St.]

cos  $\varphi$

26 A / 220  $\mu$ s

23

37

37

59

0,95



LG 346, BG 32, HG 22

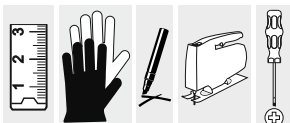



Installation erfordert  
Elektro-Fachkraft!

Symbole nach ISO 7010



### Allgemeine Sicherheitshinweise

- Der elektrische Anschluss muss ordnungsgemäß nach geltenden Normen und den nationalen sowie internationalen Sicherheits- und Unfallverhütungsvorschriften erfolgen.
- Beschädigte Leuchten dürfen nicht betrieben werden.
- Keine Haftung für Schäden durch unsachgemäßen Einsatz.
- Bei Instandsetzung nur Originalteile verwenden.
- Tragfähigkeit der Decke und Befestigungselemente sicherstellen.

### Betrieb der Leuchte

- Die unzulässigen Umgebungstemperaturen reduzieren die Lebensdauer der Leuchte, im Extremfall droht der Frühausfall.
- Zur Vermeidung von EMV-Problemen die Durchgangsverdrahtung nicht entlang der Leuchtenverdrahtung führen.
- Steuereingänge von dimmbaren Leuchten mit handelsüblichen für Netzspannung geeigneten Leitungen anschließen.

### Manipulationen unserer Produkte sind unzulässig

Veränderung, Umarbeitung, Umkennzeichnung von Produkten sowie deren Verpackung sind unzulässig und verletzen u.a. unsere eingetragenen Warenzeichenrechte. Solche Modifikationen können technische Eigenschaften unserer Produkte negativ beeinflussen, diese zerstören und möglicherweise Folgeschäden an anderen Objekten verursachen. Für durch derartige Modifikationen verursachte Schäden kann der Hersteller in keinem Fall verantwortlich gemacht werden.



Installation requires  
a qualified electrician!

Symbols according  
to ISO 7010



### General Safety Information

- Electric connection must be appropriate according to all applicable standards and other national and international safety and accident prevention regulations.
- Damaged luminaires must not be operated.
- No liability is accepted for damages resulting from improper use.
- Use genuine parts only for repair.
- Ensure stability of the ceiling and fastening elements.

### Operation of the luminaire

- Exceeding the permissible ambient temperature will reduce the luminaire's lifecycle, resulting in premature failure in extreme cases.
- Avoid ESD problems by not routing feed-through wiring directly along the wiring of the luminaire.
- Connect control inputs of dimmable luminaires with standard cables suitable for power supply voltage.

### Manipulation of our products is not permitted

Modifications, reworking, re-labelling of products as well as their package is not permitted and infringes, amongst others, our registered trademark rights. Such modifications may affect technical properties of our products, damage them and possibly cause consequential damage to other objects. The manufacturer shall not be responsible under any circumstances for damage caused by such modifications.



Bei Fragen zu unseren Symbolen, besuchen Sie folgende Webseite:  
If you have any questions about our signs, visit the following website:



[https://www.rzb.de/fileadmin/assets/downloads/PDF/RZB\\_Symbolklaerung.pdf](https://www.rzb.de/fileadmin/assets/downloads/PDF/RZB_Symbolklaerung.pdf)

**EEK** 

Dieses Produkt enthält eine Lichtquelle der Energieeffizienzklasse E entsprechend Verordnung (EU) 2019/2015

This product contains a light source of energy efficiency class E according to regulation (EU) No 2019/2015

 →  Jede zersprungene Schutzabdeckung ist zu ersetzen. DIN EN 60598

 →  Replace any cracked protective shield. IEC DIN EN 60598

 Die Lichtquelle dieser Leuchte ist nicht ersetzbar, wenn die Lichtquelle ihr Lebensdauerende erreicht hat, ist die gesamte Leuchte zu ersetzen. DIN EN 60598-1 / IEC 60598-1

The light source of this luminaire is not replaceble, when light source reaches its end of life the whole luminaire shall be replaced. DIN EN 60598-1 / IEC 60598-1

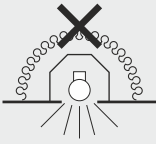
 Nicht zur Abdeckung mit Wärmedämm-Material geeignete Leuchten!

Not to be covered with thermal insulation material!

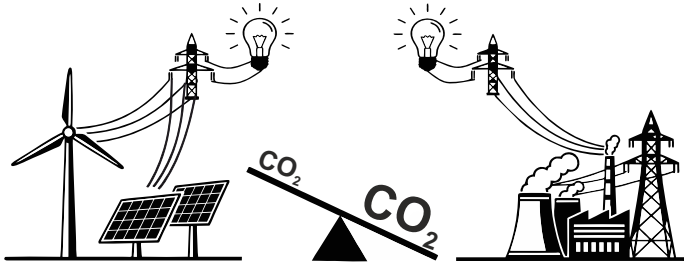
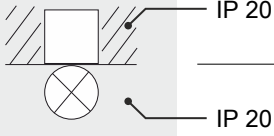

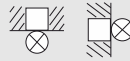

1

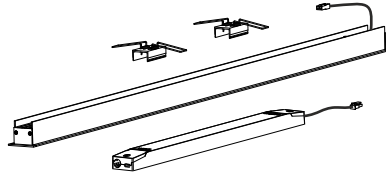

2

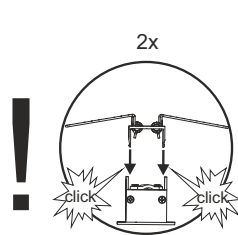
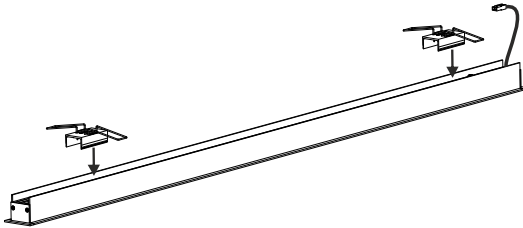

3

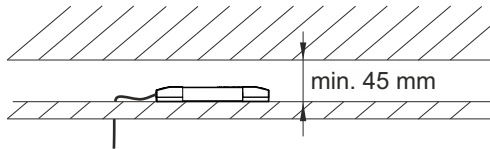

4

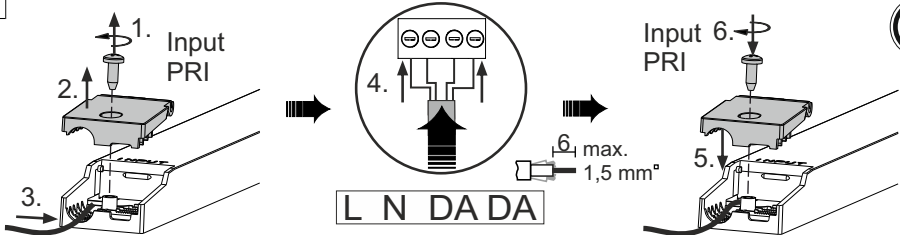

5

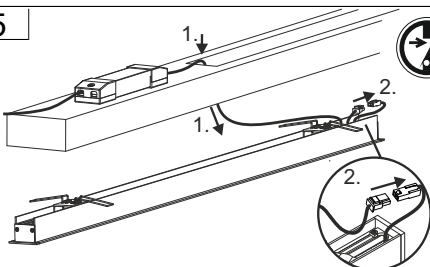

6

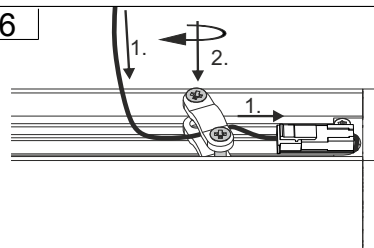

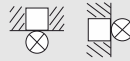

7

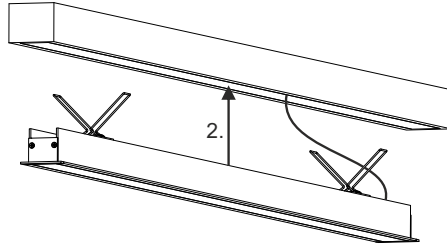
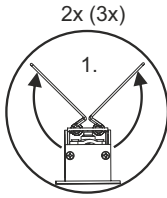

8

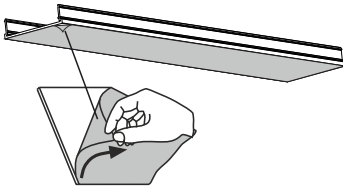

9

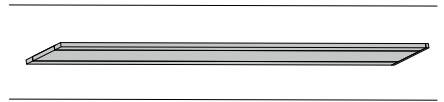

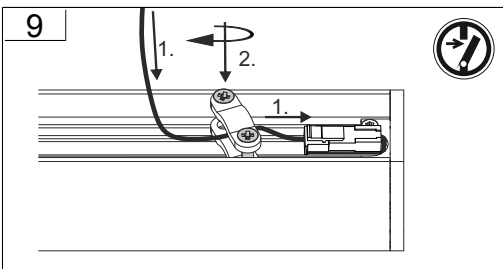
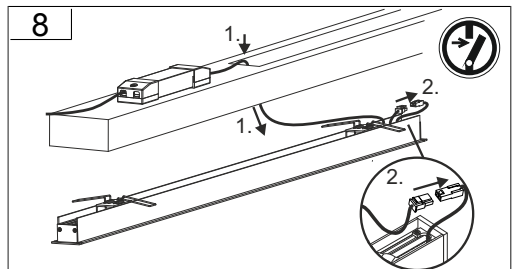
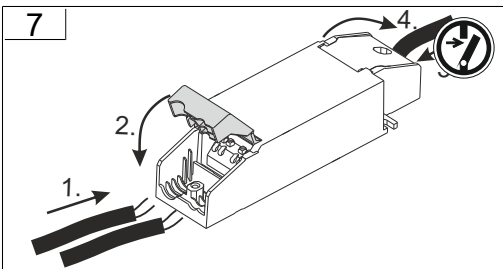
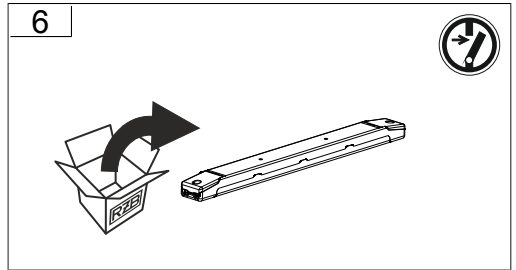
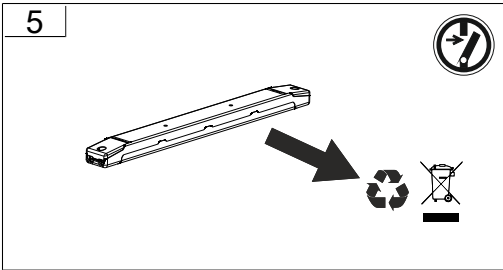
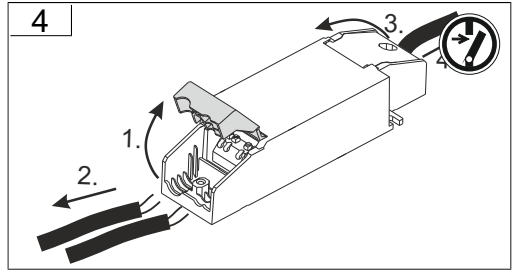
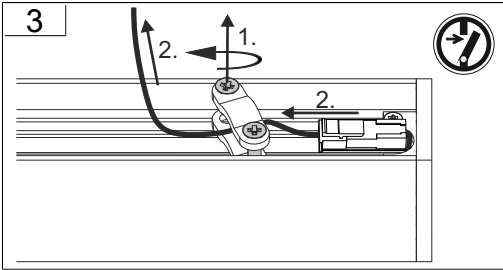
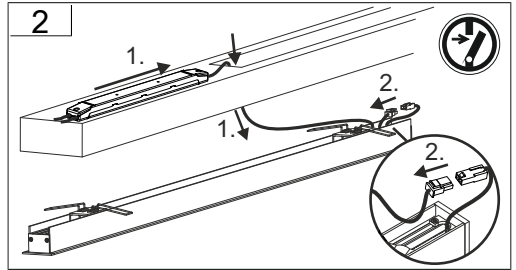
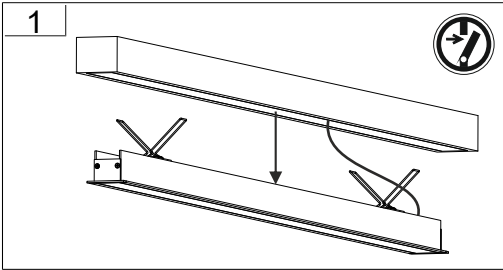



10

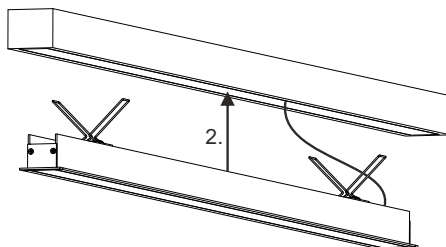
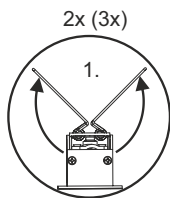

11





1

Diagram 1 shows a long, thin rectangular light fixture with a textured surface. A circular icon with a diagonal slash and a downward arrow is in the top right corner.

2

Diagram 2 shows the light fixture from step 1 being inserted into a long, thin rectangular housing. Two downward arrows indicate the insertion points. A circular icon with a diagonal slash and a downward arrow is in the top right corner.

3

Diagram 3 shows the light fixture with a recycling symbol and an arrow pointing to it, indicating it is made of recycled material. A circular icon with a diagonal slash and a downward arrow is in the top right corner.

4

Diagram 4 shows the light fixture being placed into a box with the RZB logo. A curved arrow indicates the direction of movement. A circular icon with a diagonal slash and a downward arrow is in the top right corner.

5

Diagram 5 shows the light fixture being inserted into a long, thin rectangular housing. Two upward arrows indicate the insertion points. A circular icon with a diagonal slash and a downward arrow is in the top right corner.

6

Diagram 6 shows the light fixture with a checkmark icon, indicating it is ready for use. A circular icon with a diagonal slash and a downward arrow is in the top right corner.

a

Diagram a shows the light fixture with a recycling symbol and an arrow pointing to it, indicating it is made of recycled material. A circular icon with a diagonal slash and a downward arrow is in the top right corner.

b

Diagram b shows the light fixture being inserted into a long, thin rectangular housing. A downward arrow indicates the insertion point. A circular icon with a diagonal slash and a downward arrow is in the top right corner.

c

Diagram c shows the light fixture with a recycling symbol and an arrow pointing to it, and another recycling symbol with the word "OTHER" below it, indicating it is made of other recycled material. A circular icon with a diagonal slash and a downward arrow is in the top right corner.

d

Diagram d shows the light fixture being placed into a box with the RZB logo, a shopping cart icon, and a recycling symbol, indicating it is made of recycled material. A circular icon with a diagonal slash and a downward arrow is in the top right corner.

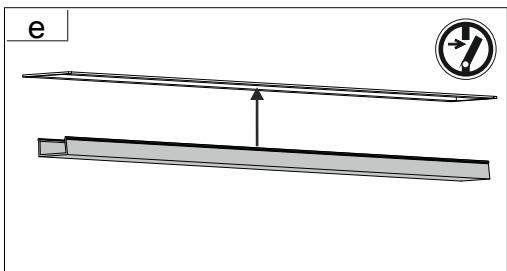

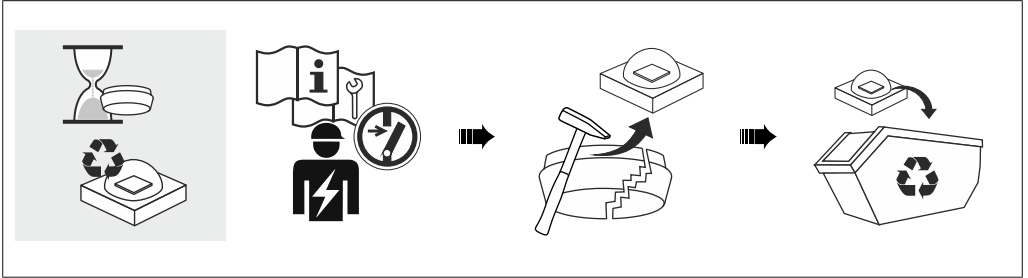

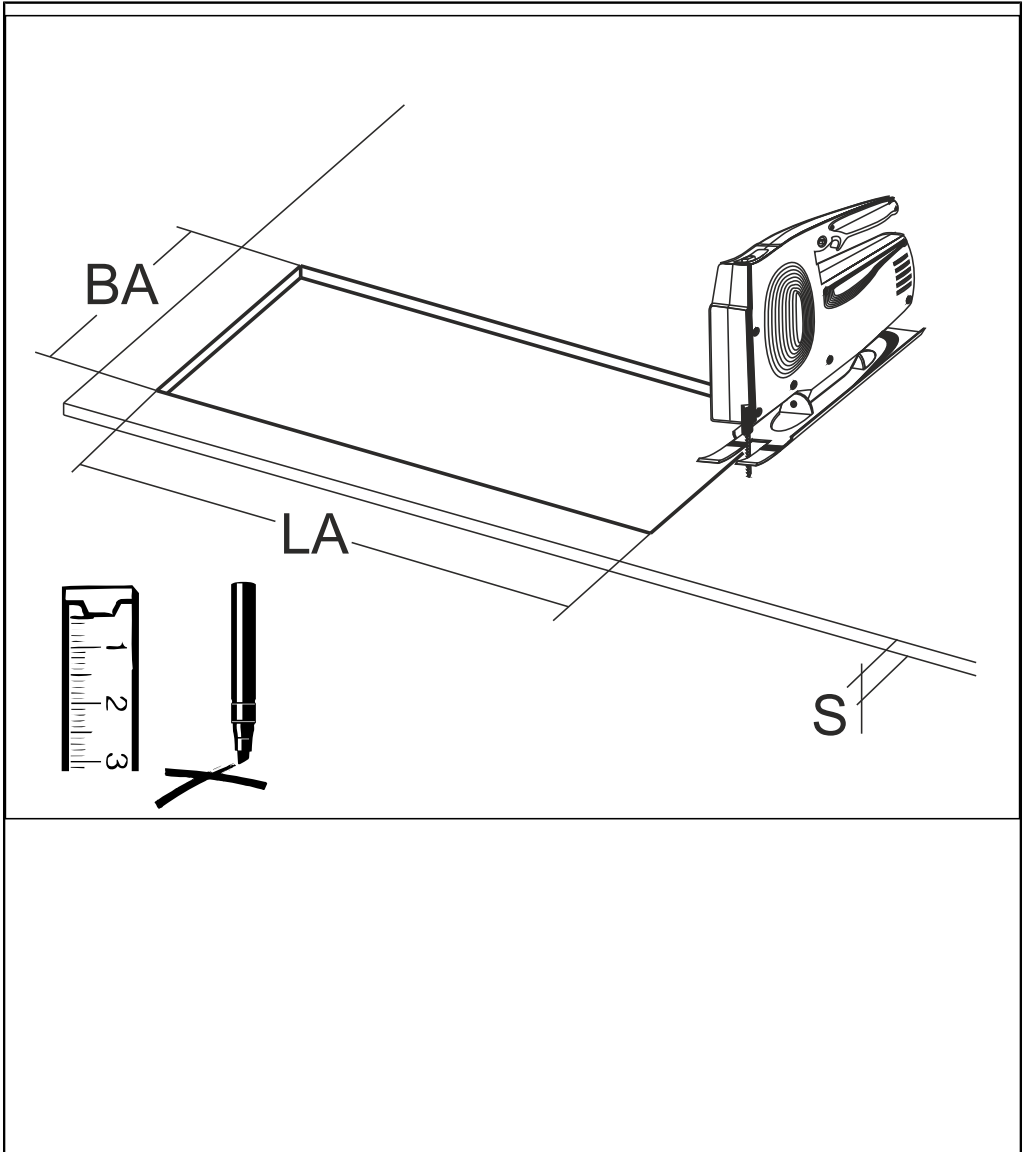

RZB - Rudolf Zimmermann, Bamberg GmbH

 Rheinstraße 16, 96052 Bamberg

 0951/7909-0

 0951/7909-198

 [info@rzb-leuchten.de](mailto:info@rzb-leuchten.de)